



4 Hotham Court Glenorchy TAS

3  1  2 

There are countless reasons as to why as human beings, exposure to the sun is not only important to our physical health, but spiritual as well.

4 Hotham Court is a north facing, open plan, split level home that attracts an abundance of light throughout and its charm and sunny disposition proves impossible to resist coming home to.

- 3-bedroom, split level family home with a sun filled outlook
- North Facing
- Stunning polished timber floors throughout
- Beautifully appointed kitchen overlooking the open dining and living area
- All bedrooms have built in storage
- Separate bathroom and second toilet perfect when going

Price : \$ 528,000
Building Size : 97 sqm
Land Size : 647 sqm
View : <https://www.4one4.com.au/property/4-hotham-court-glenorchy-tas/7741709>



John McGregor
0419 892 104



Chris McGregor
0407 421 177

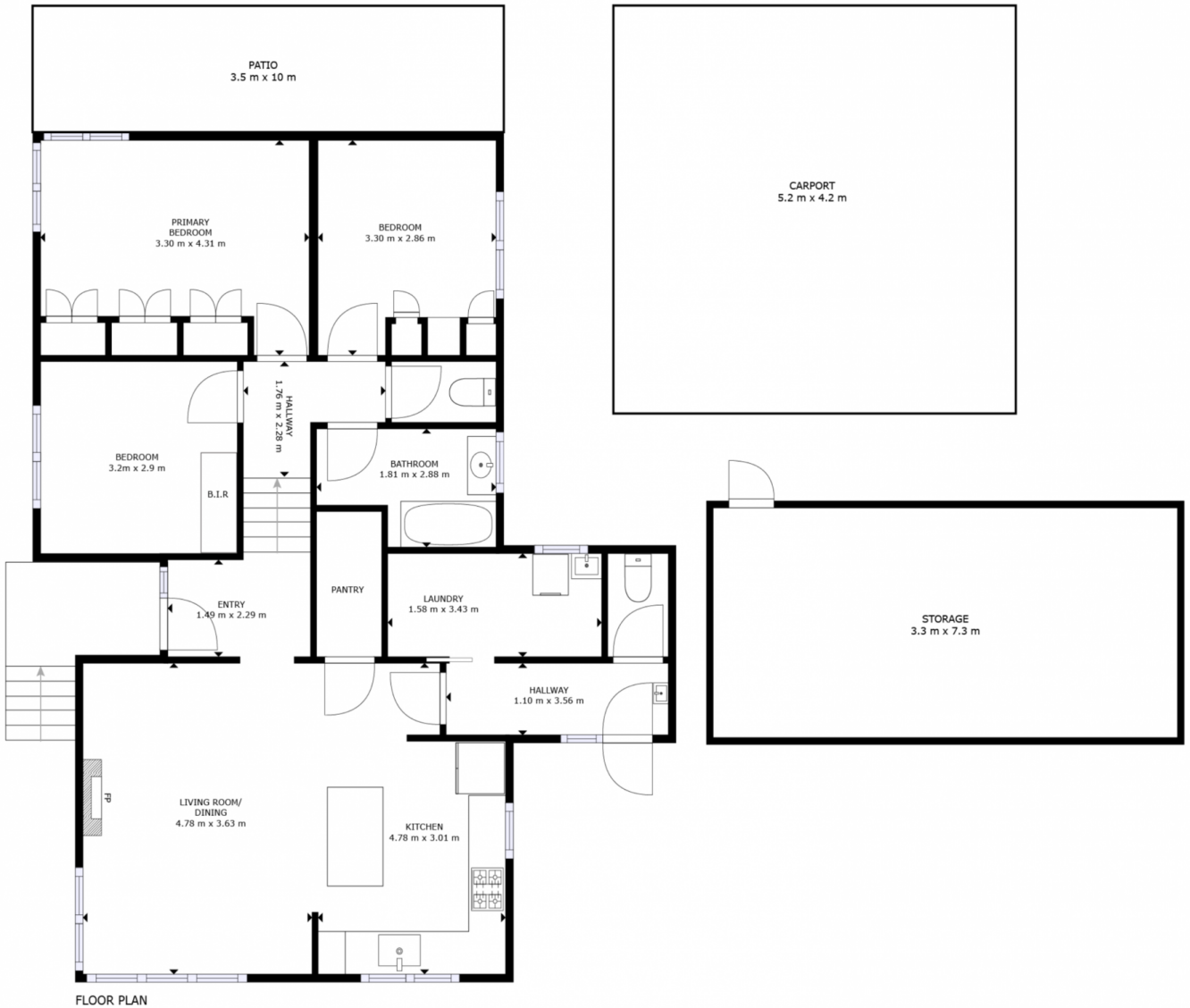

FLOOR PLAN

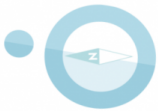

FLOOR PLAN: 97m2
 SIZES AND DIMENSIONS ARE APPROXIMATE, ACTUAL MAY VARY.

4ONE4.
 PROPERTY CO.