



### 44 Stanley Street Oatlands TAS

3 1 2

Step back in time with this stunning Georgian sandstone home, built in 1850 and rich in history. While the interior is ready for a full renovation, the solid sandstone brickwork, roof, and guttering are all in excellent condition, providing a strong foundation for restoration.

Offering spacious open-plan living and the benefit of solar power, this property also boasts clear access to a generous backyard with terrific views over Lake Dulverton and the iconic Callington Mill. Ideally located just a short stroll from Oatlands' local services and specialty shops, this home presents a rare opportunity to bring a piece of history back to life.

Don't miss your chance to secure this remarkable slice of

[For full version visit the website](https://www.4one4.com.au/property/44-stanley-street-oatlands-tas/8263331)

**Type** : House  
**Price** : \$ 300,000  
**Building Size** : 119 sqm  
**Land Size** : 605 sqm  
**View** : <https://www.4one4.com.au/property/44-stanley-street-oatlands-tas/8263331>



**Martin Evans**  
 0362 737 414

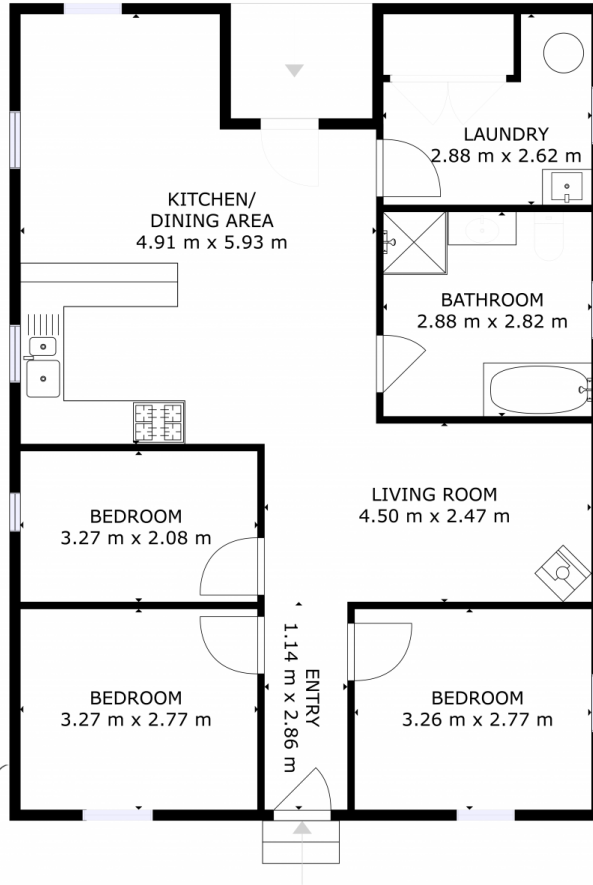

**OATLANDS. 44 Stanley Street**

GROSS INTERNAL AREA  
TOTAL: 119 m<sup>2</sup>

SIZES AND DIMENSIONS ARE APPROXIMATE, ACTUAL MAY VARY.

**4ONE4.**  
PROPERTY CO.